



Technical Bulletin

G-Series Multiple-Load Handler Outer Arm Replacement

Cascade has determined a limited number of G-Series Multiple-Load Handler units were shipped with sub-standard welds in the outer arms. A dealer will be supplied outer arms to replace outer arms on units produced during a specific production period.

This bulletin describes outer arm replacement, wear pad replacement, fork tip alignment and outer arm return information.

IMPORTANT: Dealers must replace the outer arms according to the outlined procedures. Replaced arms must be returned to Cascade. Refer to the back of this bulletin and the attached warranty claim for additional instructions. Filing a warranty claim and returning a defective part confirms that the work had been completed.



WARNING: Failure to replace the outer arms promptly could result in attachment failure, personal injury or property damage.

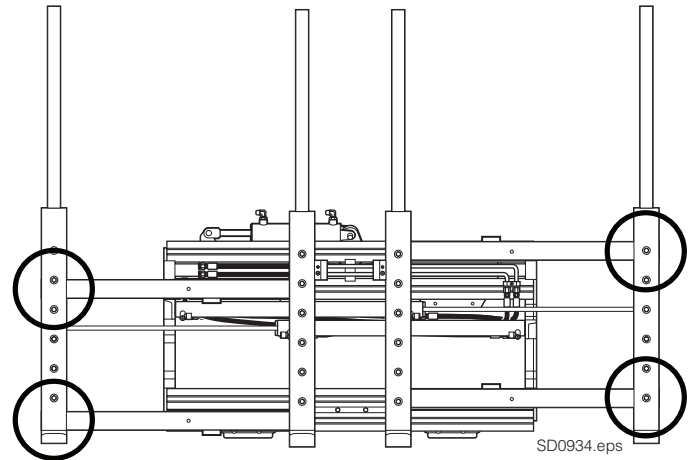

Four outer arm
weld locations

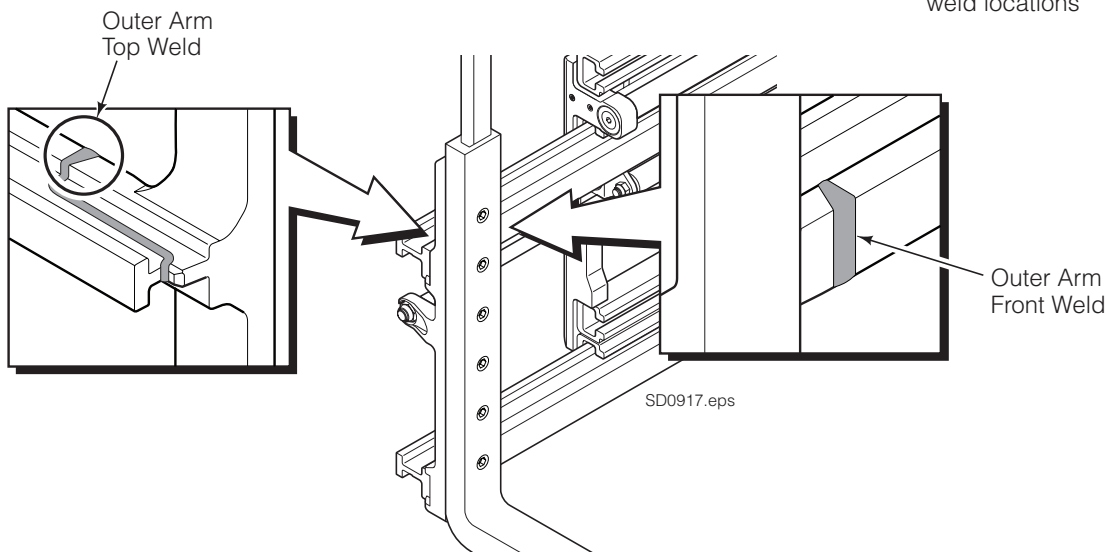

NOTE: This information should not be interpreted as the basis for warranty claims unless so designated.

cascade[®]
corporation

For Technical Support . . .

Call: 1-800-CASCADE (227-2233)

OR

Write: Cascade Corporation, PO Box 20187, Portland, OR 97294-0187

To Order Parts . . .

Call: 1-888-CASCADE (227-2233)

OR

Write: Cascade Corporation, 2501 Sheridan Ave., Springfield, OH 45505

Outer Fork and Arm Removal

- 1 Position the outer forks slightly open from fully closed to access the four outer arm fork stops. Mark the fork stop locations with a felt pen for reassembly. Remove **all four** bolt-on stops from the outer arms using a 6 mm allen wrench. **See NOTE below for removing second stop from top.** For reassembly, tighten the socket screws to a torque of 24 ft.-lbs. (32 Nm).
- 2 Open the outer forks to full width. Position the forks 3 ft. (1m) above the floor.
- 3 Remove the nut from the cylinder rod end. If the nut is difficult to remove, hydraulically open the forks while removing the nut. Retract the cylinder rod or support the cylinder with a cable tie. For reassembly, tighten the nut to a torque of 52 ft.-lbs. (70 Nm).
- 4 Lower the forks to the ground. Remove the fork from the outer arm. Lay the fork on the ground. Mark the fork LH or RH. For reassembly, double torque the capscrews to 200 ft.-lbs. (270 Nm).
- 5 Pull the outer arm out of the frame. Cylinder rod extension tool (Part No. 6151448) can be installed on the cylinder rod to help push the arm out of the frame. Mark the outer arm 'cracked' with a felt pen.
- 6 For reassembly, reverse the above procedures except for the following:
 - Lift the inner forks when sliding in the outer arms to avoid damaging the inner fork wear pads.
 - Replace the inner carrier wear pads as described in the next section.
 - Align the fork tips (if required) as described in the next section.



WARNING: Due to the weight of the parts being serviced, it is recommended that steel toed boots be worn when servicing the outer arms and forks.

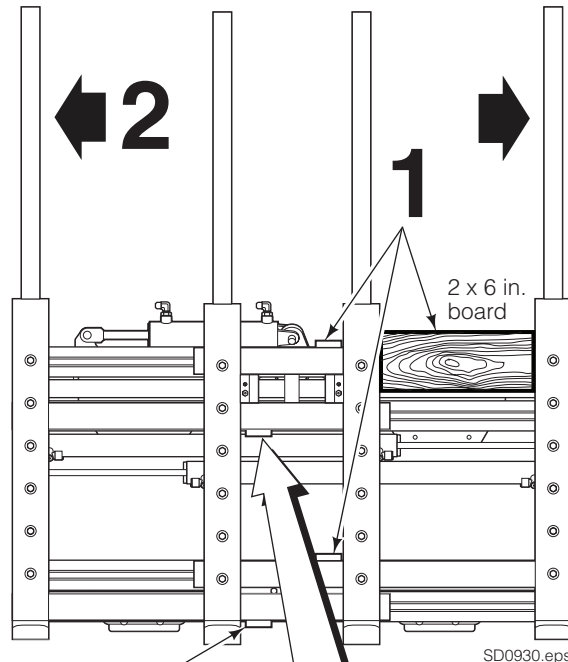

SD0930.eps

1



NOTE: For stop access in this location, place an 11 in. long, 2 x 6 in. board between the forks. Close the forks. Remove stop cap screws.

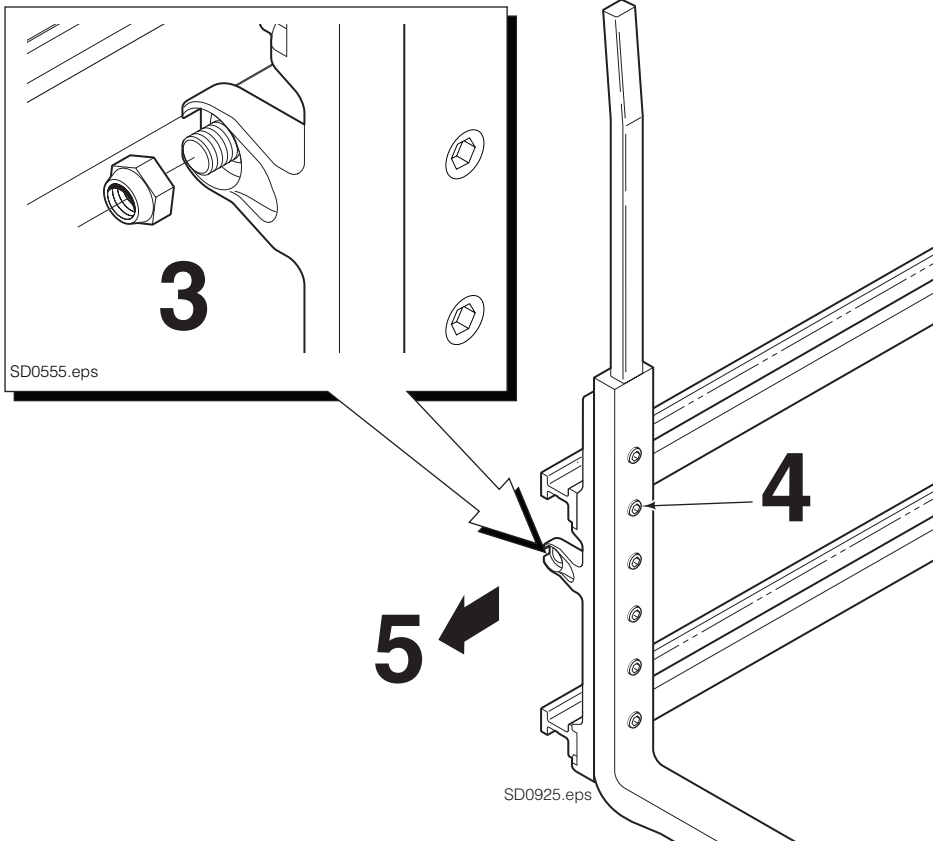

Wear Pads and Fork Tip Alignment

1 Replace the inner fork wear pads. Remove a wear pad by prying from the left or right side. Use a C-Clamp and flat plate against the pad to press the new wear pad in place.

IMPORTANT: If the wear pad plastic carrier is broken, you will have to swing the inner fork to the side to drive out the broken boss. Remove all inner fork capscrews except the top one. Swing the fork to the side to drive out the broken boss. For reassembly, double torque the capscrews to 200 ft.-lbs. (270 Nm).

2 Fully close forks.

3 Measure the vertical offset of the forks 5 in. (125 mm) from the tip of the forks. Outer forks can have a maximum vertical offset of .25 in. (7 mm) above the inner fork. The inner fork must be lower than the outer fork.

NOTE: If the inner fork is above the outer fork, the inner fork carrier will need to be replaced with the latest design carrier.

4 Fully open forks.

5 Measure the vertical offset of the forks. Outer fork can have a maximum vertical offset of .25 in. (7 mm) above or 0 in. (0 mm) below the inner fork.

6 To align forks, open outer forks so that the inner fork carrier can be accessed.

7 Lift fork carrier enough to access brake pad. Loosen brake pad by prying from the left or right and slide a shim(s) between brake pad and fork carrier.

IMPORTANT: Do not exceed .12 in. (3 mm) of shims in stack.

8 Check vertical offset of outer fork carrier by repeating steps 1 through 4.

9 When fork height offset is set within the values above, bend the shim tabs to keep in place.

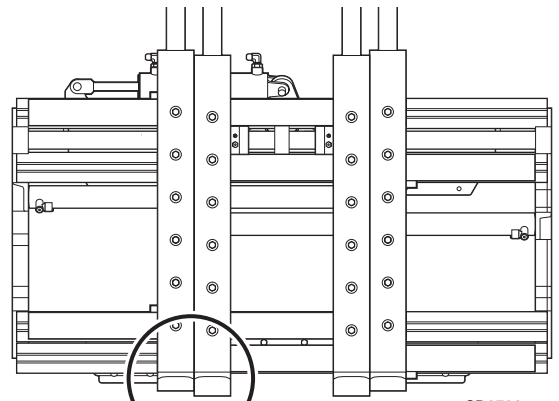

SD0783.eps

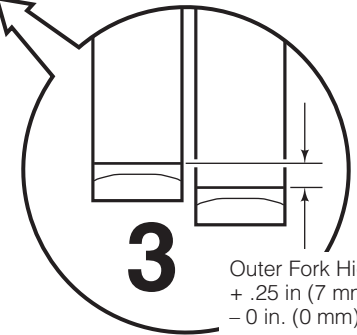

3 Outer Fork Higher
+ .25 in (7 mm)
- 0 in. (0 mm)

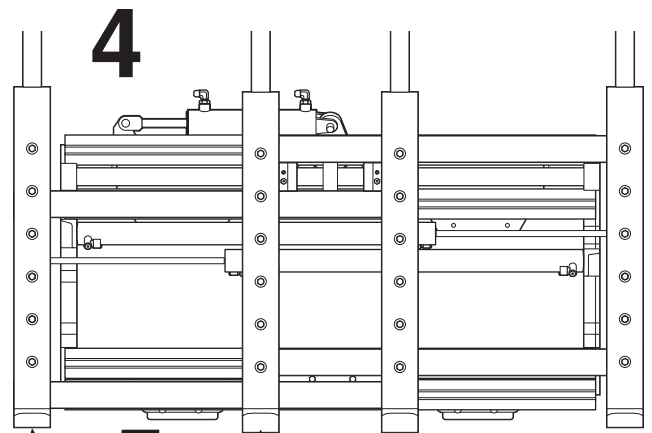

SD0784.eps

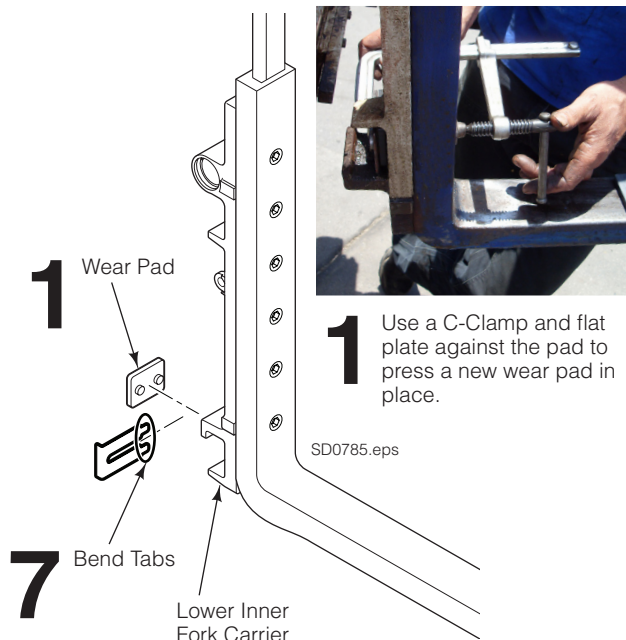
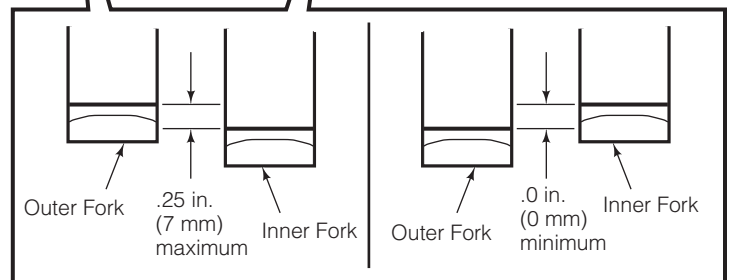

SD0785.eps

Return Information

Step 1 Fill out Warranty Claim Form

FAX to: 888-329-8207

OR

Mail to: Cascade Corporation
PO Box 20187
Portland, OR 97220

Step 2 Place outer arms on a pallet. Band the arms securely in place.

Step 3 Address shipment to:

Cascade Corporation
2501 Sheridan Ave.
Springfield, OH 45505
PIFC 47519-S8

Mark Bill of Lading:

Item Number 104780
Sub 3 Class 60

Step 4 Contact Conway Freight for collect shipment to Cascade. 800-755-2728.